

FEATURES	BENEFITS
<ul style="list-style-type: none"> Extremely small outside dimensions Patented seal design Available with a locking sleeve Plastic dust caps as standard 	<ul style="list-style-type: none"> Non-drip connection & disconnection Optional locking sleeve provides security against involuntary disconnection
SPECIFICATIONS	
Nominal flow diameter	2.5 mm (3.32")
Flow capacity	5.8 l/min (1.3 GPM UK)
Max. working pressure	2000 bar or 2500 bar – see table
Min. burst pressure	5000 bar
Temperature range	-30°C to +100°C (-22°F to +212°F)
Coupling material	Hardened, zinc chromate plated steel
Nipple material	Hardened, zinc chromate plated steel
Seal material	NBR

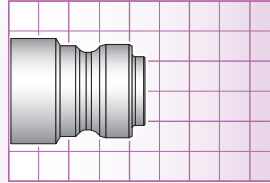

Not actual size

Single or Double Shut-off



Nipple not to be pressurised in disconnected position



COUPLINGS

125 SERIES BSPP FEMALE 2000 bar (29007 psi)



105

PART NUMBER	THREAD
C101251202	1/4" BSPP

BSPP FEMALE – 2500 bar (36259 psi)

C101251203	1/4" BSPP
------------	-----------

125 SERIES 90° BSPP FEMALE 2500 bar (36259 psi)



105

PART NUMBER	THREAD
C101251248	1/4" BSPP

NIPPLES

125 SERIES BSPP FEMALE 2000 bar (29007 psi)

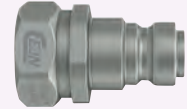

105

PART NUMBER	THREAD
C101256202	1/4" BSPP

BSPP FEMALE – 2500 bar (36259 psi)

C101256203	1/4" BSPP
------------	-----------

125 SERIES BSPP MALE – UNVALVED 2000 bar (29007 psi)



105

PART NUMBER	THREAD
C101255252	1/4" BSPP

Do you also need?



High pressure adaptors



Find it on pages 138 – 139, section three

