

SINGLE & REINFORCED CLAMP PARTS & ACCESSORIES

**LIGHT DUTY  
POLYPROPYLENE JAWS  
METRIC**



8630

PART NUMBER	TUBE OD	GROUP
D-A106C	6 DIN	1
D-A108C	8 DIN	1
D-A110C	10 DIN	1
D-A112C	12 DIN	1
D-A214C	14 DIN	2
D-A215C	15 DIN	2
D-A216C	16 DIN	2
D-A218C	18 DIN	2
D-A319C	19 DIN	3
D-A320C	20 DIN	3
D-A322C	22 DIN	3
D-A323C	23 DIN	3
D-A325C	25 DIN	3
D-A428C	28 DIN	4
D-A430C	30 DIN	4
D-A535C	35 DIN	5
D-A538C	38 DIN	5
D-A540C	40 DIN	5
D-A542C	42 DIN	5
D-A644.5C	44.5 DIN	6
D-A650.8C	50.8 DIN	6

**IMPERIAL**

PART NUMBER	NOMINAL BORE	GROUP
D-A213.2C	1/4"	2
D-A216.7C	3/8"	2
D-A321.3C	1/2"	3
D-A426.7C	3/4"	4
D-A648.3C	1 1/2"	6

**CLAMPING ROD  
CARBON STEEL**



8630

PART NUMBER	SIZE
D-TS14A	1 metre length

**EXTENDED WELDING PLATE  
CARBON STEEL**



8630

PART NUMBER	GROUP
D-APT1	1
D-APT2	2
D-APT3	3
D-APT4	4
D-APT5	5

**STACKING LOCKING PLATE  
CARBON STEEL**

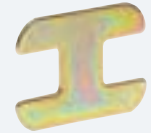

8630

PART NUMBER	GROUP
D-APA1	1
D-APA2	2
D-APA3	3
D-APA4	4
D-APA5	5

**STACKING BOLT  
CARBON STEEL**



8630

PART NUMBER	GROUP
D-AVTA1	1
D-AVTA2	2
D-AVTA3	3
D-AVTA4	4
D-AVTA5	5

**RAIL NUT  
CARBON STEEL**



8630

PART NUMBER	THREAD
D-TC6A	M6
D-TC8A	M8

**JOINING PLATE  
CARBON STEEL**



8630

PART NUMBER	GROUP
D-APAG1	1
D-APAG2	2
D-APAG3	3