

PRODUCT SERIES SPECIFICATIONS

Series: BLQ

Category: Liquid Cooling

Pressure: Vacuum to 200 psi, 13.8 bar

Temperature: 0°F to 240°F (-17°C to 115°F)

Spillage & Air Inclusion: ≤0.015 cc per disconnect at 0 psi and ≤0.063 cc per disconnect rated at 200 psi ≤0.063 cc per connect

Material Compliance

Reach: Compliance

RoHS: Compliance

For more information see cpcworldwide.com or contact us at cpcworldwide.com/ContactUs

Interactive 3D graphic, click to activate and rotate.

The BLQ2 Series and the RPLQ4 quick disconnect couplings provide ultra-reliable, dripless connections and disconnections that protect valuable electronics. Designed specifically for rack mounted liquid cooling applications, RPLQ4 utilizes patent-pending valve technology that eliminates drips and is able to withstand long-term use. provide ultra -reliable dripless connections and disconnections that protect valuable electronics. Designed specifically for rack-mounted liquid cooling applications, the BLQ2 Series and the RPLQ4 use patent pending valve technology that eliminates drips and is able to withstand long-term connection.

Features - Benefits

Non-spill design - Disconnect under pressure

Redundant sealing with connected - Extra protection from contaminants and debris

Friction-free valve - Valving system designed for extended periods in the connected state

Ruggedness - Able to withstand long-term use, repeated use

Axial engagement tolerance - Valves designed to allow full flow even when not fully engaged

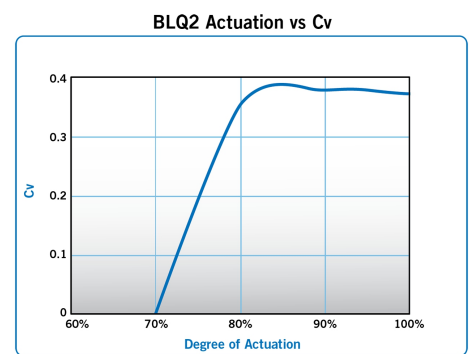
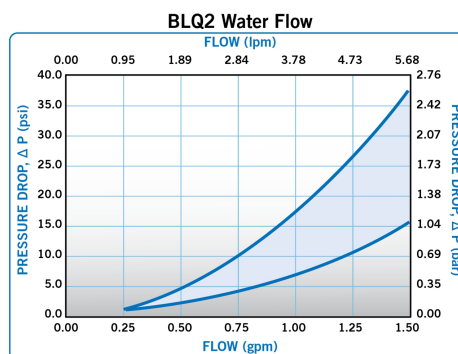
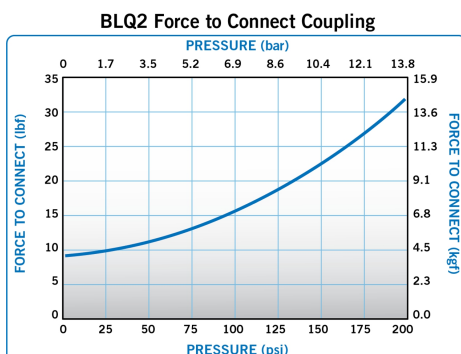

These graphs are intended to give you a general idea of the performance capabilities of each product line. Contact CPC for flow of a particular coupling combination.

Technical details:

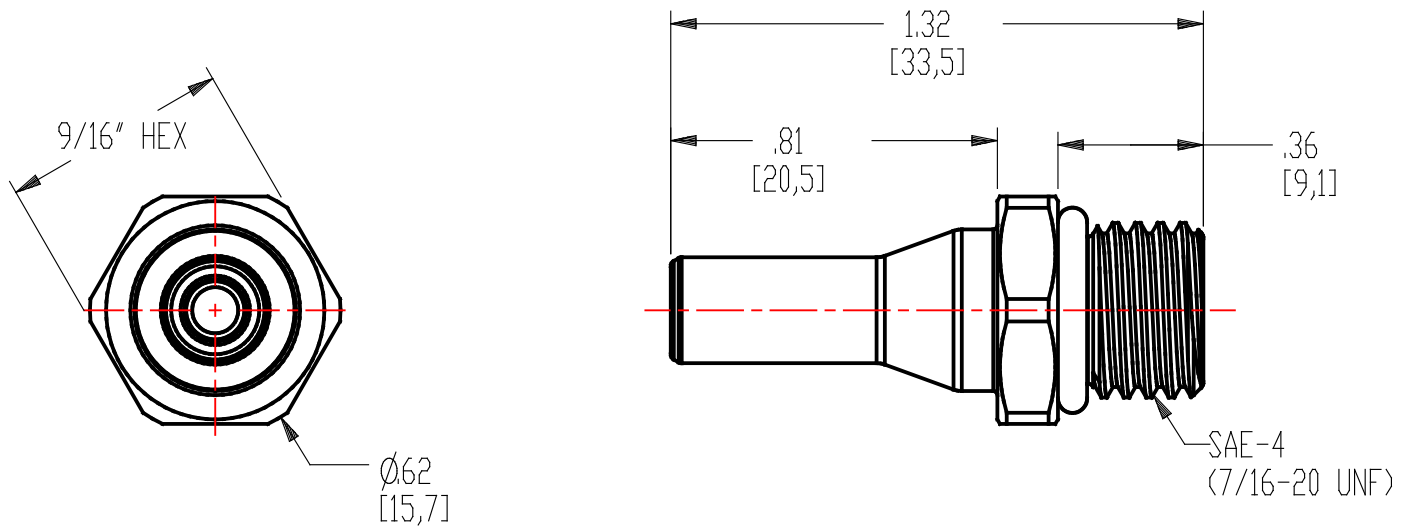

Description: 1/4" Rack and Panel SAE-04 Valved In-Line Liquid Cooling Coupling Insert

Materials:

Main Components: Chrome plated Brass

Valve: Polysulfone

Valve Spring: Stainless Steel

Seals: EPDM

Others: Polysulfone retainer, LDPE and silicone caps

Standard Packaging Quantity: 10