

# SaveAir®

## PRESET REGULATOR FOR AIR



### SaveAir®

The SaveAir is a diaphragm operated, preset pressure regulator.

The SaveAir® can be used everywhere where air pressure needs to be reduced to a fixed pressure without the need for adjustment. The Inline construction is small and compact which makes it ideal and simple for supply line installations.

The pressure is factory set and cannot be tampered with, so that the machine or application is protected against manual pressure manipulation. This characteristics make it an ideal solution on trucks or any human operated machines.

The ToolReg® prevents “dynamic pressure waste”. This arises when the pressure and flow at the withdrawal point are unnecessarily higher than those specified by the manufacturer to achieve the desired function. “Dynamic pressure waste” is extremely costly, a waste of energy that may be found throughout the industry.

### Your advantages

- ✓ Factory preset pressure
- ✓ Locked to prevent pressure change - tamper proof
- ✓ Supplies tools exclusively with the specified pressure
- ✓ No pressure gauge needed
- ✓ Prevents compressed air waste
- ✓ Saves energy – reduces costs
- ✓ Highly reliable
- ✓ Light weight - Small and compact size
- ✓ Increased tool service life



## Technical data

Max. inlet pressure:	18 bar
Outlet pressure (preset):	1... 8 bar
Flow:	400... 800 NI/min
Connection:	1/4" BSP 1/4" NPT
Temperature range:	0°C to 60°C
Weight:	80g

## Applications

General pneumatic application	Pneumatic supply lines
Pump, flow stabilization	Automotive
Pneumatic power tools	Workshop equipment

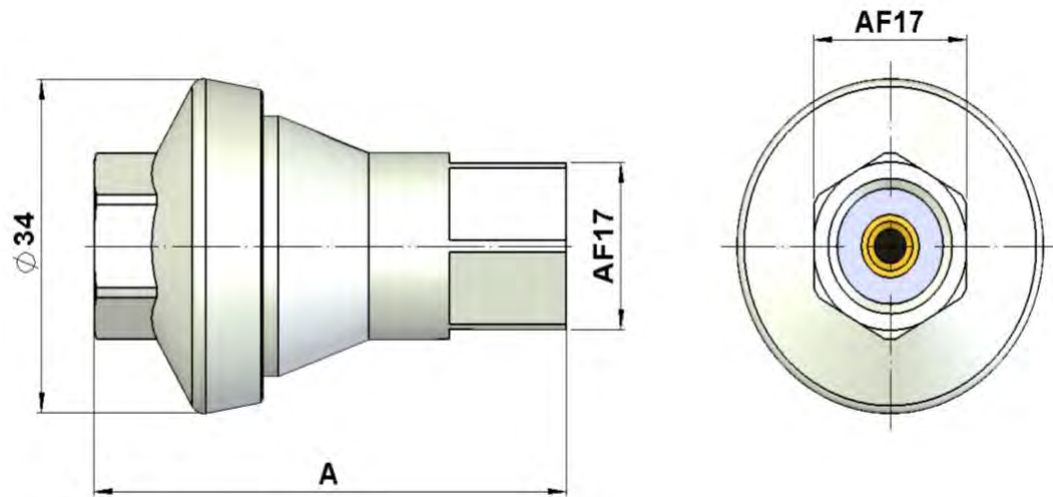

\*Dimensions see datasheet on website – [protect-air.com](http://protect-air.com)

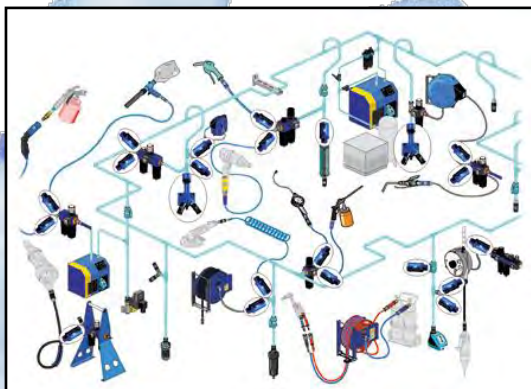

TRI-MATIC AG  
Bösch 82  
6331 Hünenberg

CH-

Phone +41 (0)41 780 22 22  
Email: [info@tri-matic.ch](mailto:info@tri-matic.ch)



a brand of tri-matic